

32404022

10 HOLES $\phi 10$. CSK FROM BOTH SIDES $1 \times 90^\circ$ (SEE SECTION A-A)

20 HOLES M10-8H. (SEE SECTION A-A) DRILL AS PER FIG. WITH BASE $\phi 365^{+0.12}$ CSK $1 \times 90^\circ$

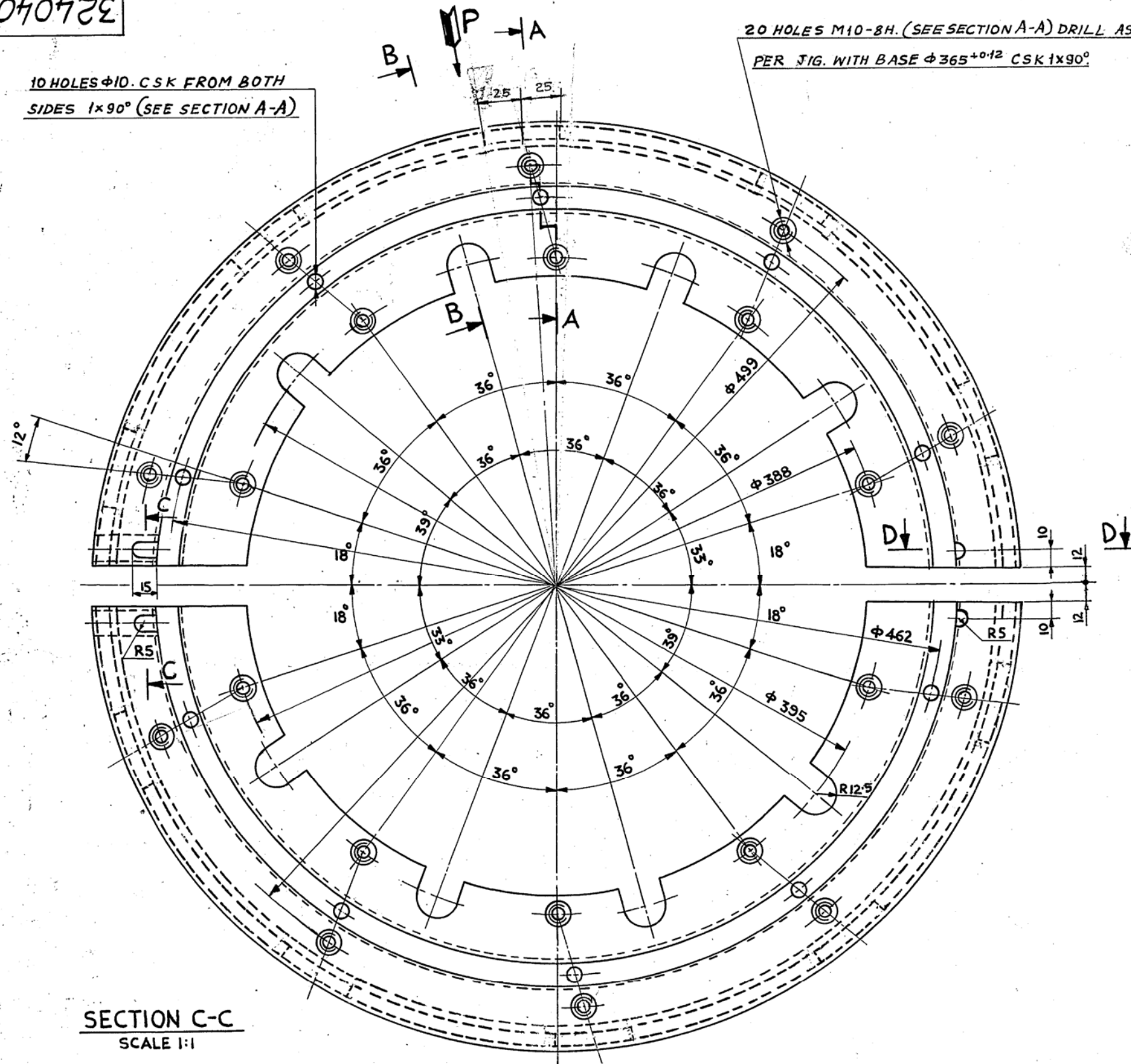

SECTION A-A
SCALE 1:1
(TURNED)

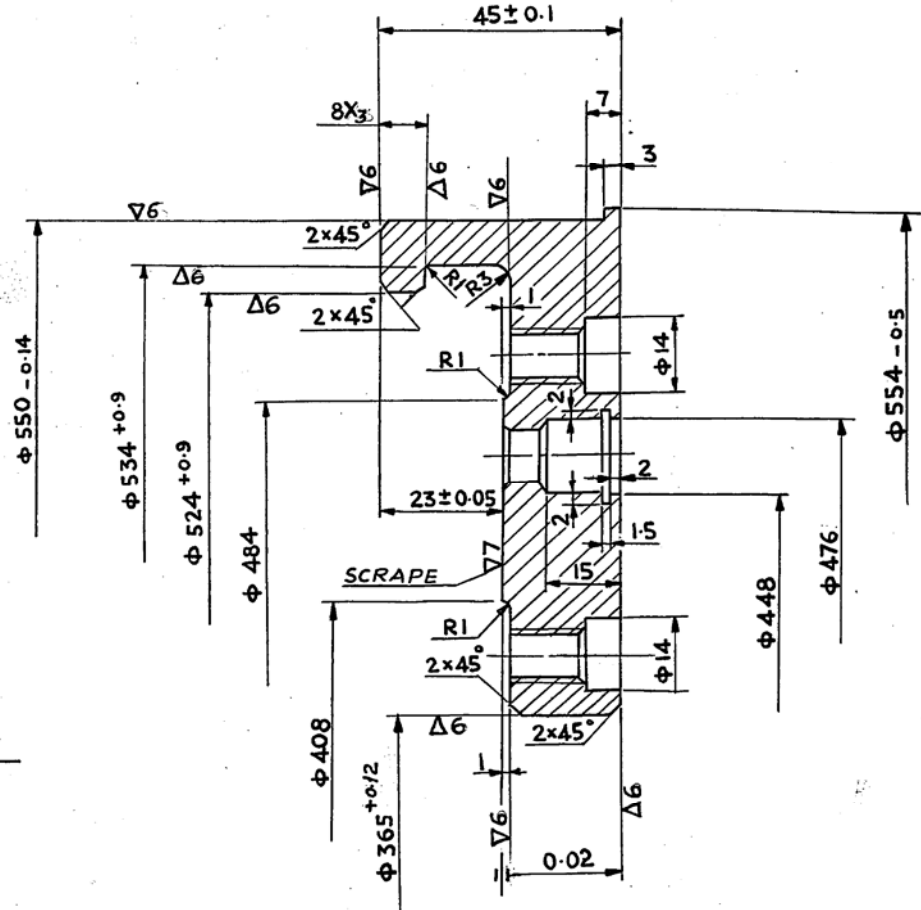

SECTION B-B
SCALE 1:1
(TURNED)

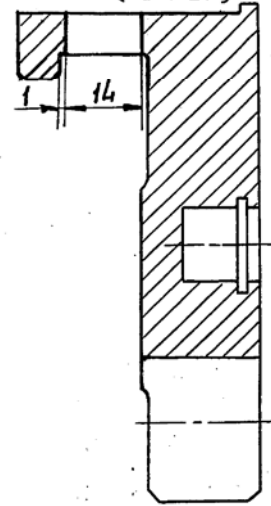

SECTION C-C
SCALE 1:1

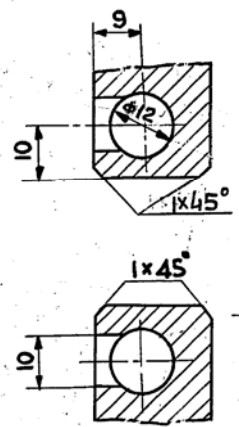

VIEW P (UNFOLDED)
SCALE 1:1

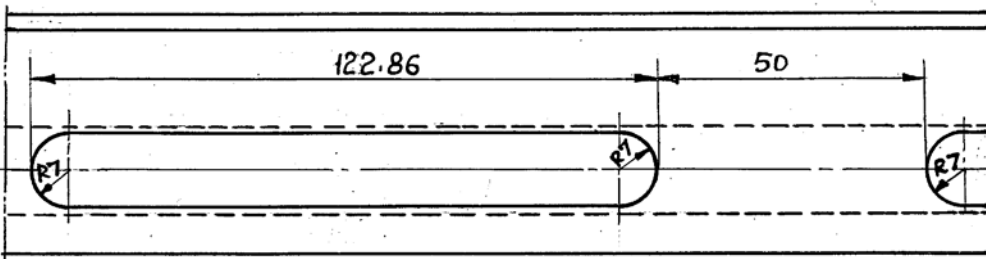

SECTION D-D
SCALE 1:1

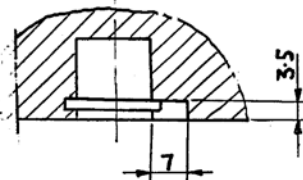

				C-200-130	3240400
				THRUST WORKING RING	32404
CHG. NOS.	DOCU. NO.	SIGN.	DATE	LETTER	WEIGHT
WORKED	P. SINGH	<i>P.S.</i>	28/4/22	- B	240
CHECKED	P. SINGH	<i>P.S.</i>	28/4/22		
SUPERVISE					
TECH. CONT.	Manchanda	<i>Manchanda</i>	16/5/22		
STD. CONT.	RPL	<i>RPL</i>	3/7		
APPROVED	J.N. KARAN	<i>J.N. KARAN</i>	4/7/22		
DRAWN/TRACED					
				STEEL	
				st. 42-W IS: 2062-62	SHEET-1 TOTAL
				MCM 3 GOST 500-58	HEEP 5